

# Flat Washers - Type B (Regular)

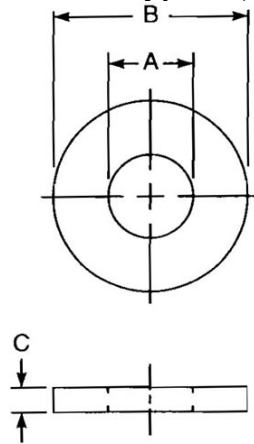

DIMENSIONAL DATA		
Type: Flat Washers - Type B (Regular)	Standard: ASME B18.21.1-2009	Size: 3/4
Nominal: 0.75	A - Inside Diameter: 0.842 - 0.805	B - Outside Diameter: 2.030 - 1.993
C - Thickness: 0.112 - 0.090		
MATERIAL DATA		
Typical Material: Silicon-Bronze (UNS C65100 or C65500)	Hardness: HRB 90 min.	
FINISH DATA		
Finish Type: Plain	K factor (ref. DIN 946): 0.2	RoHS/REACH Compliant: yes
Color: colorless		

